

ASAHI/AMERICA

NEW PRODUCT BULLETIN

DATE: 11/24/2000
TO: Asahi/America Distributors
FROM: Leo Lester, Dave Hurley, Kenichi Miyazaki
SUBJECT: Expanded Product line
ITEM: TYPE 14 FLANGED DIAPHRAGM VALVES

35 Green Street
P.O. Box 653
Malden, MA
Toll Free: 800-343-3618
Fax: 781-321-4421
Internet:
www.asahi-america.com
Email:
asahi@asahi-america.com

We have expanded the line of **Type 14 Flanged Diaphragm Valves**, which were introduced in 1999. At that time, the Type 14 was only available in sizes from 1/2" through 2". Now, the Type 14 size range runs *through 4"*.

TYPE 14 – Flanged Sizes 1/2"–4"

Materials: PVC, CPVC, PP, PVDF

- **IMPROVED SEALING DESIGN** – Body, bonnet, and diaphragm are designed using state-of-the-art technology for better sealing capabilities with low compressive strain. The increased sealing surface eliminates the need for exterior metal reinforcement brackets.
- **NEW DIAPHRAGM DESIGN** – Bayonet connection used to couple the compressor to the diaphragm permits quick exchanges of diaphragm with less downtime.
- **REDUCED SEATING TORQUE** – Valve design maintains even pressure over the face of the Diaphragm in full closed position, reducing necessary handwheel torque.
- **LOW PROFILE** – Handwheel easier to turn because of low profile gauge cover. The Type 14 is ideal for installation in areas and equipment with limited space.
- **NEW MOLDED PANEL-MOUNT DESIGN** – Integral, molded panel mount feature provides safe installation and proper piping support.
- **INTERCHANGEABILITY WITH TYPE G** – Face-to-face dimensions are the same as Type G; the Type 14 Flanged model directly replaces Type G valves without requiring spacers or modifications.
- **IMPROVED DESIGN POSITION INDICATOR/TRAVEL STOP** – Travel Stop system protects diaphragm. "At-a-Glance" Position Indicator recesses into the handwheel when "Fully Closed."
- **AUTOMATION WITH NO BODY MODIFICATIONS** – The same valve body is used in manual and automated applications (sizes 1/2" – 2" only).

Accessories

Stem extensions • Operating nuts • Locking devices • Manual limit switches • Pneumatic and electric actuators • PVDF gas barrier • Other diaphragm materials

Availability

Ready for immediate shipment.

Part Numbers **1461005 (through 040) – 1468005 (through 040)**

Pricing

The pricing of the Type 14 will be the same as that of the Type G Diaphragm Valves.

If we can be of further assistance, please do not hesitate to contact us.

Enclosed is an updated set of drawings.

ASAHI/AMERICA

NEW PRODUCT BULLETIN

DATE: 11/24/2000

TO: Asahi/America Distributors

FROM: Leo Lester, Dave Hurley, Kenichi Miyazaki

SUBJECT: Expanded Product Line

ITEM: TYPE 14 TRUE UNION SOCKET, THREADED,
AND SPIGOTDIAPHRAGM VALVES

35 Green Street

P.O. Box 653

Malden, MA

Toll Free: 800-343-3618

Fax: 781-321-4421

Internet:

www.asahi-america.com

Email:

asahi@asahi-america.com

We have expanded the line of **Type 14 Diaphragm Valves**, which were introduced in 1999. At that time the Type 14 was available in FLANGED VERSIONS ONLY. Now, the Type 14 is available in SOCKET, THREADED, AND SPIGOT END CONFIGURATIONS, and it replaces the Type 72 "True Union" models.

TYPE 14 – "True Union" Socket, Threaded, and Spigot End Sizes 1/2"–2"

Materials: PVC, CPVC, PP, PVDF

- IMPROVED SEALING DESIGN – Body, bonnet, and diaphragm are designed using state-of-the-art technology for better sealing capabilities with low compressive strain.
- NEW DIAPHRAGM DESIGN – Bayonet connection used to couple the compressor to the diaphragm permits quick exchanges of diaphragm with less downtime.
- REDUCED SEATING TORQUE – Valve design maintains even pressure over the face of the Diaphragm in full closed position, reducing necessary handwheel torque.
- LOW PROFILE – Handwheel easier to turn because of low profile gauge cover. The Type 14 is ideal for installation in areas and equipment with limited space.
- NEW MOLDED PANEL-MOUNT DESIGN – Integral molded panel mount feature provides safe installation and proper piping support.
- IMPROVED DESIGN POSITION INDICATOR/TRAVEL STOP – Travel stop system protects diaphragm. "At-a-Glance" Position Indicator recesses into the handwheel when "Fully Closed."
- AUTOMATION WITH NO BODY MODIFICATIONS – The same valve body is used in manual and automated applications.

Accessories

Stem extensions • Operating nuts • Locking devices • Manual limit switches • Pneumatic and electric actuators • PVDF gas barrier • Other diaphragm materials

Availability

Ready for immediate shipment.

Part Numbers **1526005 (through 020) – 1549005 (through 020)**

Pricing

The pricing of the Type 14 will be the same as that of the Type 72 "True Union" models.

If we can be of further assistance, please do not hesitate to contact us.

Enclosed is an updated set of drawings.

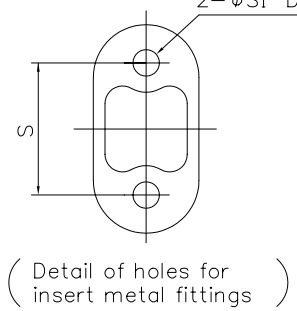
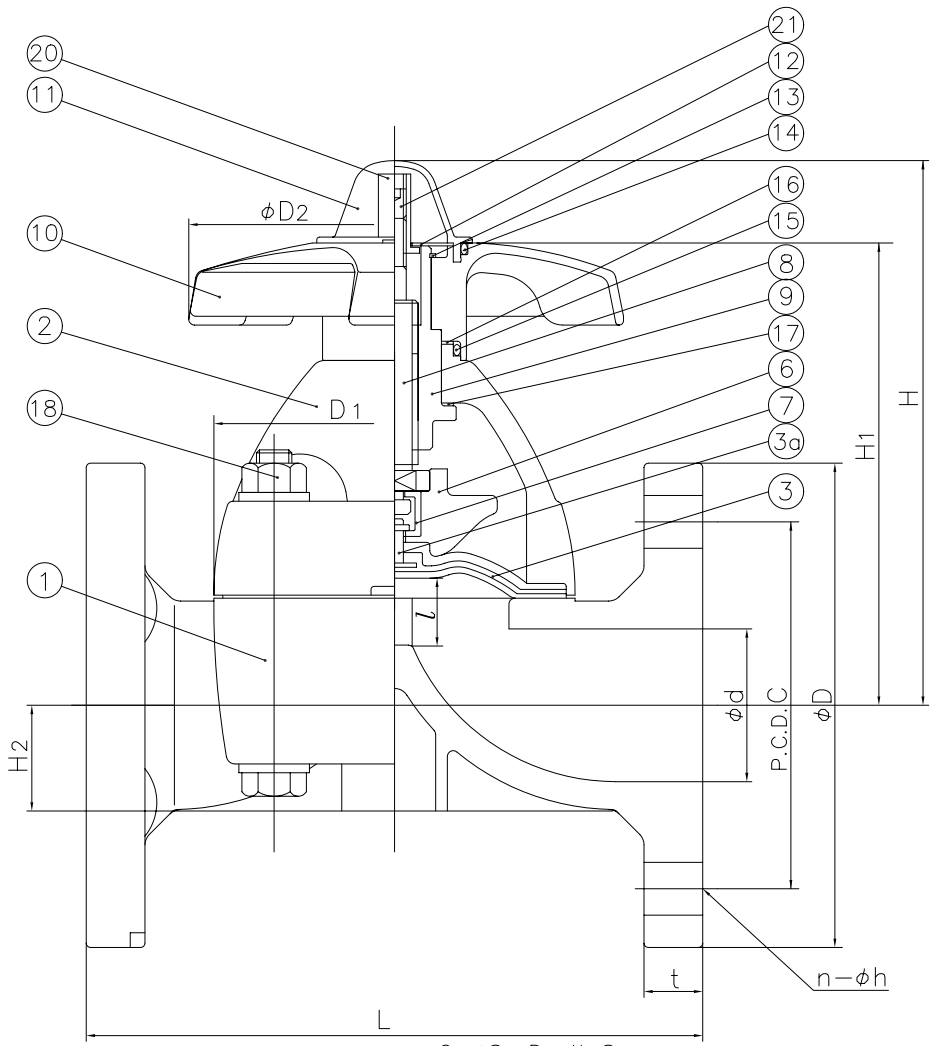

DIMENSIONS TABLE

UNIT : INCH

NOMINAL SIZE	d	ANSI Class 150				D1	D2	l (LIFT)	L	t	H	H1	H2	S	S1	S2	
		C	D	n	h												
1/2" 15mm	0.63	2.38	3.50	4	0.62	2.13x2.60	3.46	0.39	4.25	0.43	4.09	3.39	0.49	0.98	0.28	0.51	
3/4	20	0.79	2.75	3.88	4	0.62	2.13x2.60	3.46	0.39	5.88	0.51	4.17	3.46	0.57	0.98	0.28	0.51
1	25	0.98	3.12	4.25	4	0.62	2.64x3.15	3.46	0.47	5.88	0.59	4.37	3.66	0.73	0.98	0.28	0.51
1 1/4	32	1.26	3.50	4.62	4	0.62	2.64x3.15	3.46	0.47	6.38	0.63	4.57	3.82	0.89	0.98	0.28	0.51
1 1/2	40	1.57	3.88	5.00	4	0.62	4.25x4.25	6.14	0.83	6.94	0.63	6.97	5.67	1.08	1.77	0.35	0.59
2	50	2.05	4.75	6.00	4	0.75	4.84x4.84	6.14	0.98	7.94	0.79	7.52	6.22	1.42	1.77	0.35	0.59

NOTE. 1. The shape and appearance of assembly differ a little with nominal size compared to this drawing.

FOR REFERENCE ONLY
ASAHI/AMERICA

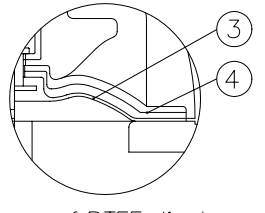
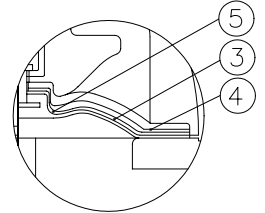

21	SCREW	1	STAINLESS STEEL 304	
20	STOPPER (A)	1	COPPER ALLOY (C3604)	
18	BOLT· NUT	4sets	<input type="checkbox"/> STAINLESS STEEL 304 <input type="checkbox"/> Others ()	
17	THRUST RING (B)	1	UHMWPE	
16	THRUST RING (A)	1	UHMWPE	
15	O-RING (B)	1	EPDM	
14	O-RING (A)	1	EPDM	
13	RETAINING RING-C TYPE	1	STAINLESS STEEL 304	
12	NAME PLATE	1	PVC	
11	GAUGE COVER	1	PC	
10	HAND WHEEL	1	PP	
9	SLEEVE	1	COPPER ALLOY (C3604)	
8	STEM	1	COPPER ALLOY (C3604)	
7	JOINT	1	STAINLESS STEEL 304	
6	COMPRESSOR	1	PVDF	
5	PVDF GAS BARRIER	1	PVDF	used for PVDF BODY/PTFE DIA.
4	CUSHION	1	EPDM	used for PTFE diaphragm
3a	INSERTED METAL OF DIAPHRAGM	1	STAINLESS STEEL 304	
3	DIAPHRAGM	1	<input type="checkbox"/> EPDM <input type="checkbox"/> PTFE <input type="checkbox"/> Others ()	
2	BONNET	1	BODY/BONNET <input type="checkbox"/> PVC/PVC <input type="checkbox"/> C-PVC/PP <input type="checkbox"/> PP/PP	
1	BODY	1	<input type="checkbox"/> PVDF/PPG <input type="checkbox"/> PVDF/PVDF	
No.	DESCRIPTION	No.REQ'D	MATERIAL	REMARKS

THIS DRAWING AND ALL INFORMATION HEREON IS THE PROPERTY OF ASAHI/AMERICA. ANY COPYING, REPRODUCTION OR UNAUTHORIZED USE IS FORBIDDEN WITHOUT WRITTEN CONSENT.

	NAME	DATE
DR	KENICHI MIYAZAKI	10/16/01
APPD	DAVE HURLEY	10/16/01
PROD	LEO LESTER	10/16/01
WO#/CO#		
FILE		

ASAHI/AMERICA
ISO 9001 CERTIFIED
35 GREEN STREET, P.O. BOX 653, MALDEN, MA.

DIAPHRAGM VALVE
TYPE14
1/2" THRU 2"

SIZE A	DWG. NO. 0055DI	REV D
SCALE NTS	SHEET 1 OF 1	

FOR REFERENCE ONLY
ASAHI/AMERICA

DIMENSIONS TABLE

UNIT : inch

NOMINAL SIZE	d	ANSI Class 150					D ₁	D ₂	l (LIFT)	L	t		H	H ₁	H ₂	S	S ₁	S ₂
		C	D	n	h	PVC C-PVC					PP PVDF							
2½"	65mm	2.64	5.50	7.00	4	0.75	6.89	8.66	1.34	9.84	0.87	0.91	10.47	7.40	2.40	3.35	0.43	0.79
3	80	3.07	6.00	7.50	8	0.75	7.91	8.66	1.65	10.38	0.87	0.91	11.02	7.95	2.48	3.94	0.59	1.10
4	100	3.94	7.50	9.00	8	0.75	9.49	10.12	1.97	12.94	0.87	0.94	12.95	9.49	3.07	4.72	0.59	1.10

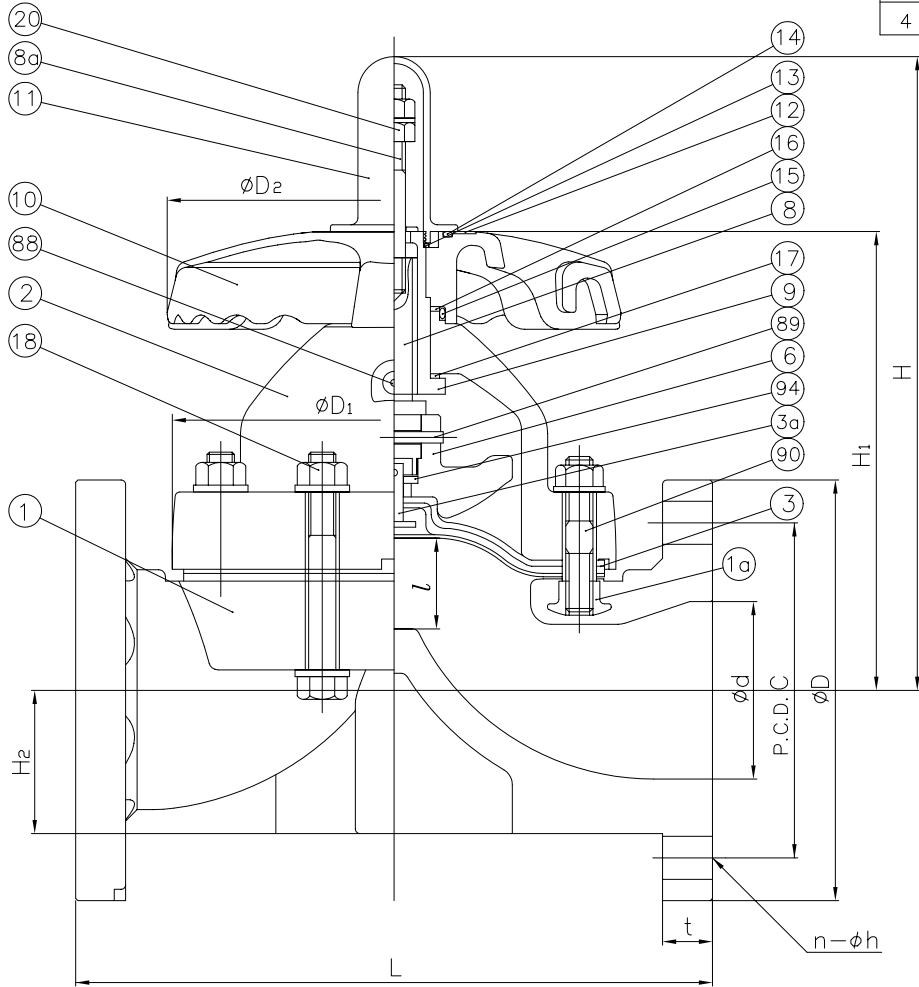

NOTE. 1.The shape and appearance of assembly differ a little with nominal size compared to this drawing.

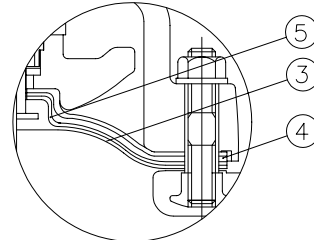

In case of PVDF body and PTFE diaphragm

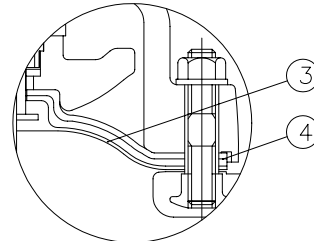

In case of PTFE diaphragm

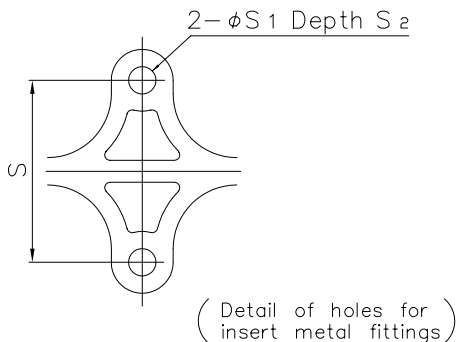

No.	DESCRIPTION	No.REQ'D	MATERIAL	REMARKS
1a	INSERTED NUT	4	COPPER ALLOY (C3604) STAINLESS STEEL 304	used for PVC, C-PVC,PP body used for PVDF body
94	METAL OF COMPRESSOR	1	STAINLESS STEEL 304	
90	STUD BOLT· NUT	4sets	□ STAINLESS STEEL 304 □ Others ()	
89	COMPRESSOR PIN	1	STAINLESS STEEL 304	
88	GREASE NIPPLE	1	COPPER ALLOY (C3604)	
20	STOPPER	1	STAINLESS STEEL 304	
18	BOLT· NUT	4sets	□ STAINLESS STEEL 304 □ Others ()	
17	THRUST RING (B)	1	UHMWPE	
16	THRUST RING (A)	1	UHMWPE	
15	O-RING (B)	1	EPDM	
14	O-RING (A)	1	EPDM	
13	RETAINING RING-C TYPE	1	STAINLESS STEEL 304	
12	NAME PLATE	1	PVC	
11	GAUGE COVER	1	PC	
10	HAND WHEEL	1	PP	
9	SLEEVE	1	COPPER ALLOY (C3604)	
8a	INDICATING ROD	1	STAINLESS STEEL 304	
8	STEM	1	COPPER ALLOY (C3604)	
6	COMPRESSOR	1	PVDF	
5	PVDF GAS BARRIER	1	PVDF	used for PVDF body/PTFE DIA.
4	CUSHION	1	EPDM	used for PTFE diaphragm
3a	INSERTED METAL OF DIAPHRAGM	1	STAINLESS STEEL 304	
3	DIAPHRAGM	1	□ EPDM □ PTFE □ Others ()	
2	BONNET	1	BODY/BONNET □ PVC/PVC □ C-PVC/PP □ PP/PP	
1	BODY	1	□ PVDF/PPG □ PVDF/PVDF	

THIS DRAWING AND ALL INFORMATION HEREON IS THE PROPERTY OF ASAHI/AMERICA. ANY COPYING, REPRODUCTION OR UNAUTHORIZED USE IS FORBIDDEN WITHOUT WRITTEN CONSENT.

	NAME	DATE
DR	KENICHI MIYAZAKI	10/24/01
APPD	DAVE HURLEY	10/24/01
PROD	LEO LESTER	10/24/01
WO#/CO#		
FILE		

ASAHI/AMERICA
ISO 9001 CERTIFIED
35 GREEN STREET, P.O. BOX 653, MALDEN, MA.

DIAPHRAGM VALVE
TYPE14
2-1/2" THRU 4"

SIZE	A	DWG. NO.	0060DI	REV	C
SCALE	NTS			SHEET	1 OF 1

ASAHI/AMERICA

NEW PRODUCT BULLETIN

DATE: 11/24/2000

TO: Asahi/America Distributors

FROM: Leo Lester, Dave Hurley, Kenichi Miyazaki

SUBJECT: New Product

ITEM: TYPE 15 FLANGED DIAPHRAGM VALVES

35 Green Street

P.O. Box 653

Malden, MA

Toll Free: 800-343-3618

Fax: 781-321-4421

Internet:

www.asahi-america.com

Email:

asahi@asahi-america.com

We have changed our Type G Diaphragm Valves in the 5" and 6" sizes and have renamed them the **Type 15 Flanged Diaphragm Valves**. The Type G valves will still be available in 8" and 10" sizes.

TYPE 15 – Flanged

Sizes 5" and 6"

Materials: PVC, PP, PVDF

- **IMPROVED SEALING DESIGN** – Body, bonnet, and diaphragm are designed using state-of-the-art technology for better sealing capabilities with low compressive strain.
- **REDUCED SEATING TORQUE** – Valve design maintains even pressure over the face of the Diaphragm in full closed position, reducing necessary handwheel torque.
- **INTERCHANGEABILITY WITH TYPE G** – Face-to-face dimensions are the same as the Type G model, no spacers or modifications are necessary.
- **IMPROVED BODY AND BONNET DESIGN** – Increased sealing surface material eliminates exterior metal reinforcement brackets necessary on the Type G Diaphragm Valves with Teflon® Diaphragms.

Accessories

- Stem extensions • Operating nuts • Locking devices • Manual limit switches • PVDF gas barrier
- Other diaphragm materials

Availability

Available for immediate shipment.

Part Number **1561050 (through 060) – 1568050 (through 060)**

Pricing

The pricing of the Type 15 will be the same as that of the 5" and 6" Type G models.

If we can be of further assistance, please do not hesitate to contact us.

Enclosed is an updated set of drawings.

FOR REFERENCE ONLY
ASAHI/AMERICA

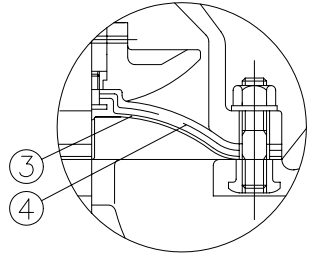

in case of PTFE diaphragm

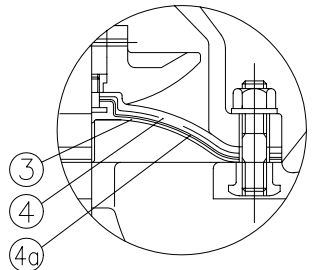

in case of PVDF body and PTFE diaphragm

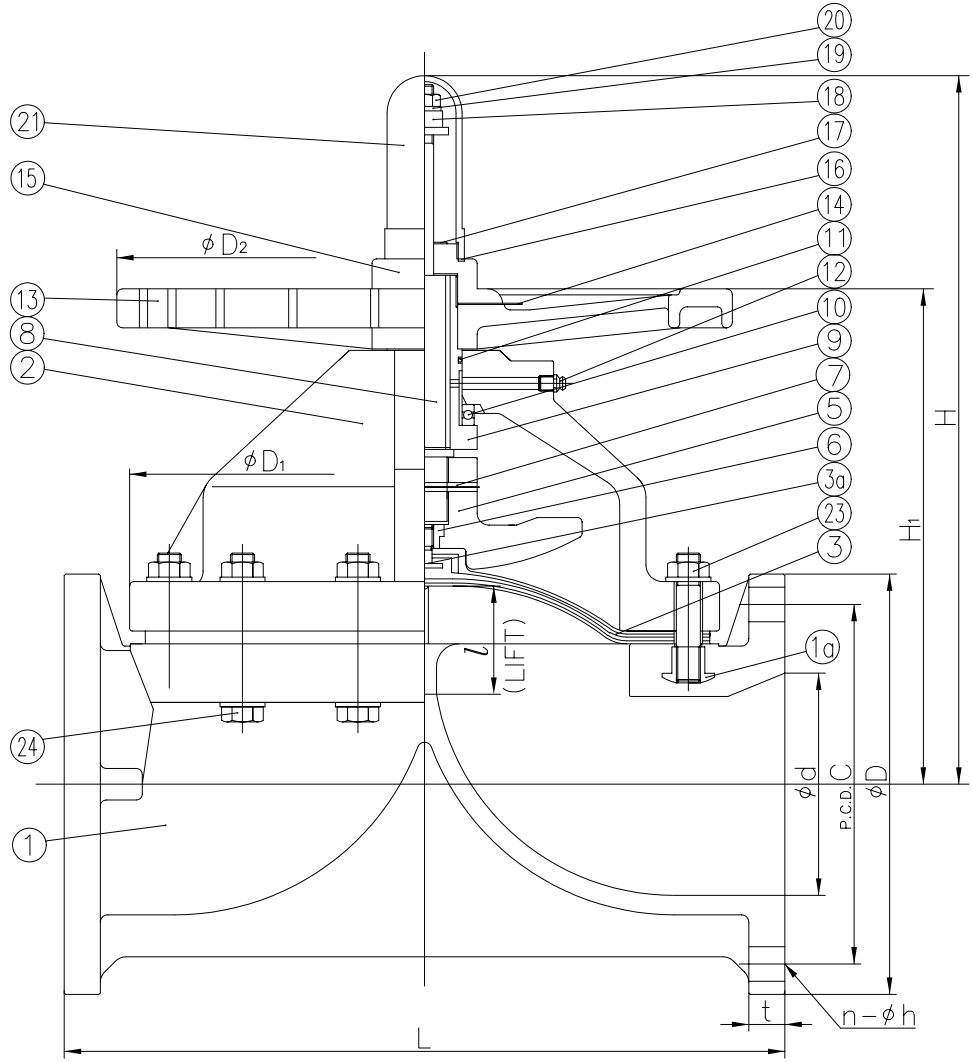

1a	INSERTED NUT	4	<input type="checkbox"/> COPPER ALLOY (C3604) used for PVC,PP body <input type="checkbox"/> STAINLESS STEEL 304 used for PVDF body <input type="checkbox"/> Others ()	
24	BOLT · NUT	—	<input type="checkbox"/> STAINLESS STEEL 304 <input type="checkbox"/> Others ()	
23	STUD BOLT · NUT	4sets	<input type="checkbox"/> STAINLESS STEEL 304 <input type="checkbox"/> Others ()	
21	GAUGE COVER	1	P · C	
20	NUT	1	STAINLESS STEEL 304	
19	SPRING WASHER	1	STAINLESS STEEL 304	
18	STOPPER	1	Chromized STEEL (SS400)	
17	SHEET RING	1	STAINLESS STEEL 304	
16	SHEET GASKET (A)	1	EPDM	
15	CAP	1	P · P	
14	NAME PLATE	1	PVC	
13	HAND WHEEL	1	P · P	
12	GREASE NIPPLE	1	COPPER ALLOY (C3604)	
11	O-RING (A)	1	NBR	
10	THRUST BEARING (A)	1	HIGH CARBON CHROMIUM BEARING (SUJ 2)	
9	SLEEVE (A)	1	COPPER ALLOY (C3604)	
8	STEM	1	COPPER ALLOY (C3604)	
7	COMPRESSOR PIN	1	STAINLESS STEEL 304	
6	COMPRESSOR NUT	1	COPPER ALLOY (C3604)	
5	COMPRESSOR	1	PVDF	
4a	PVDF GAS BARRIER	1	PVDF	used for PVDF body/PTFE DIA.
4	CUSHION	1	EPDM	used for PTFE diaphragm
3a	INSERTED METAL OF DIAPHRAGM	1	STAINLESS STEEL 304	
3	DIAPHRAGM	1	<input type="checkbox"/> EPDM <input type="checkbox"/> PTFE <input type="checkbox"/> others ()	
2	BONNET	1	BODY/BONNET <input type="checkbox"/> PVC/PVC <input type="checkbox"/> PP/PP	
1	BODY	1	<input type="checkbox"/> PVDF/PPG <input type="checkbox"/> PVDF/PVDF	
No.	DESCRIPTION	No.REQ'D	MATERIAL	REMARKS

DIMENSIONS TABLE

NOMINAL SIZE	ANSI Class 150												UNIT :inch		
	d	D	C	n	h	L	t		D ₁	D ₂	l	H	H ₁		
							PVC	PP,PVDF							
5" 125mm	4.92	10.00	8.50	8	0.88	16.14	0.87	0.94	12.60	11.81	2.36	16.54	12.13		
6 150	5.83	11.00	9.50	8	0.88	18.90	0.94	1.06	15.16	16.14	2.76	18.74	13.15		

NOTE. 1.The shape and appearance of assembly differ a little with nominal size compared to this drawing.

THIS DRAWING AND ALL INFORMATION HEREON IS THE PROPERTY OF ASAHI/AMERICA. ANY COPYING, REPRODUCTION OR UNAUTHORIZED USE IS FORBIDDEN WITHOUT WRITTEN CONSENT.

NAME	DATE
DR KENICHI MIYAZAKI	7/26/01
APPD DAVE HURLEY	7/26/01
PROD LEO LESTER	7/26/01
WO#/CO#	
FILE	

ASAHI/AMERICA

ISO 9001 CERTIFIED
35 GREEN STREET, P.O. BOX 653, MALDEN, MA.



DIAPHRAGM VALVE
TYPE 15
5" THRU 6"

SIZE	A	DWG. NO.	0061DI	REV	B
SCALE	NTS		SHEET 1 OF 1		